

WASHMASTER

MAC

SITEMASTER

OPERATING MANUAL - ALL MODELS



www.mac-international.co.uk

MAC 12/100, 15/150 & 15/200 BASIC PARTS LAYOUT

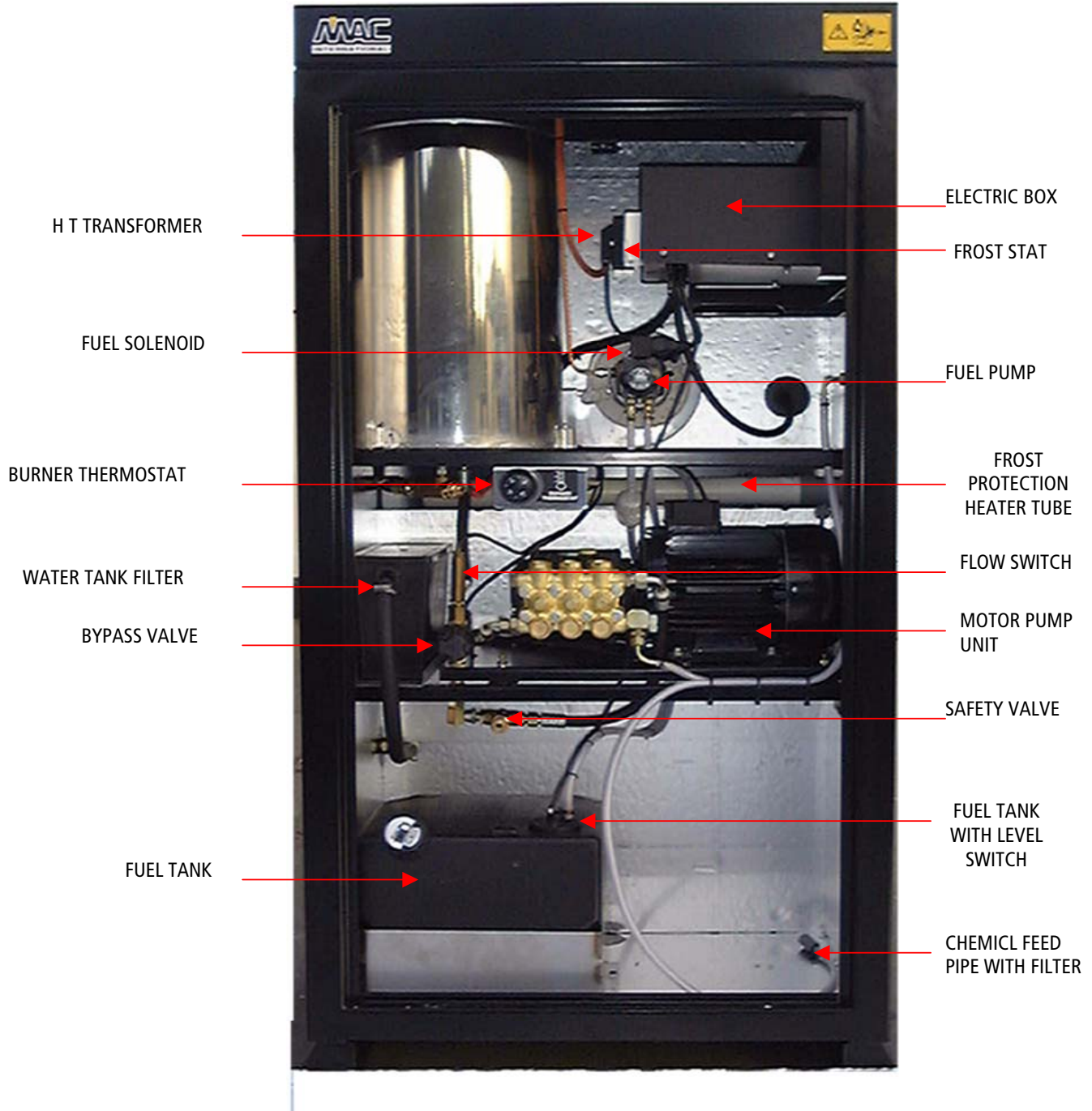

INTRODUCTION

This unit has been electrically tested with a portable appliance tester and results printed which is supplied with this machine

ELECTRICAL SUPPLY

MAC12/100 requires connection to a 16A 240v supply.

MAC15/150 requires connection to a 20A 415v five-wire supply.

MAC15/200 requires connection to a 32A 415v five-wire supply.

WARNING !!!

We recommend this unit be connected to an electrical circuit, protected with an R.C.D unit for safe usage.

INTERNAL ELECTRICAL PROTECTION

The machine has one built in thermal overload protection unit for main motor.

1 x 2 amp fuse for control transformer 240v input and frost protection.

1 x 2 amp fuse for control transformer 24v output protection.

1 x 2 amp fuse for burner protection.

All the above fuses are located within the main electrical box.

ISOLATE SUPPLY BEFORE OPENING COVER !!

If any of these should trip out this could be due to an internal electric fault: please contact your local dealer for an engineer.

WARRANTY

This machine carries a one-year parts and labour warranty.

Subject to sales and service conditions

MAINTENANCE

Regular maintenance of this unit is recommended and the use of a maintenance agreement is suggested to prolong longevity.

It is recommended that this unit should be serviced at 3 monthly intervals

FROST PROTECTION

WARNING !!!

This machine is fitted with a frost protection unit. Do not disconnect from the electrical supply when not in use. This could cause the machine to freeze in cold conditions.

FLAME CONTROL / BULK FUEL

If machine is fitted with an flame control kit unit. See appendix A.

DAILY CHECKS

1. Check mains cable for damage. Do not use this machine with a damaged cable this could result in a fatal accident.
Damaged cables must be replaced immediately.
Call your dealer for a engineer.
2. High pressure hoses should be checked for damage any Damaged hoses must be replaced.
Call your dealer for recommended hoses.
3. Check diesel in tank we recommend to use Gas Oil or Derv.

WEEKLY CHECKS

1. Check pump oil - via dipstick on top of the pump.
Recommend oil 20/50.
2. Check diesel in tank we recommend to use Gas Oil or Derv.
Weekly should be ok if your machine is connected to a bulk fuel tank.
3. Check water tank filter and clean.
4. Check fuel filter.
For replacement filter call your dealer for recommended type.

BEFORE STARTING MACHINE

1. Check water is turned on.
2. Check electric is turned on. A green lamp on the control panel indicates this. It is recommended not to turn supply off during cold weather because of frost protection unit.
3. Check R.D.C earth leakage trip is working.

4. Do not run machine without water this could damage the pump and seals.

MACHINE OPERATION

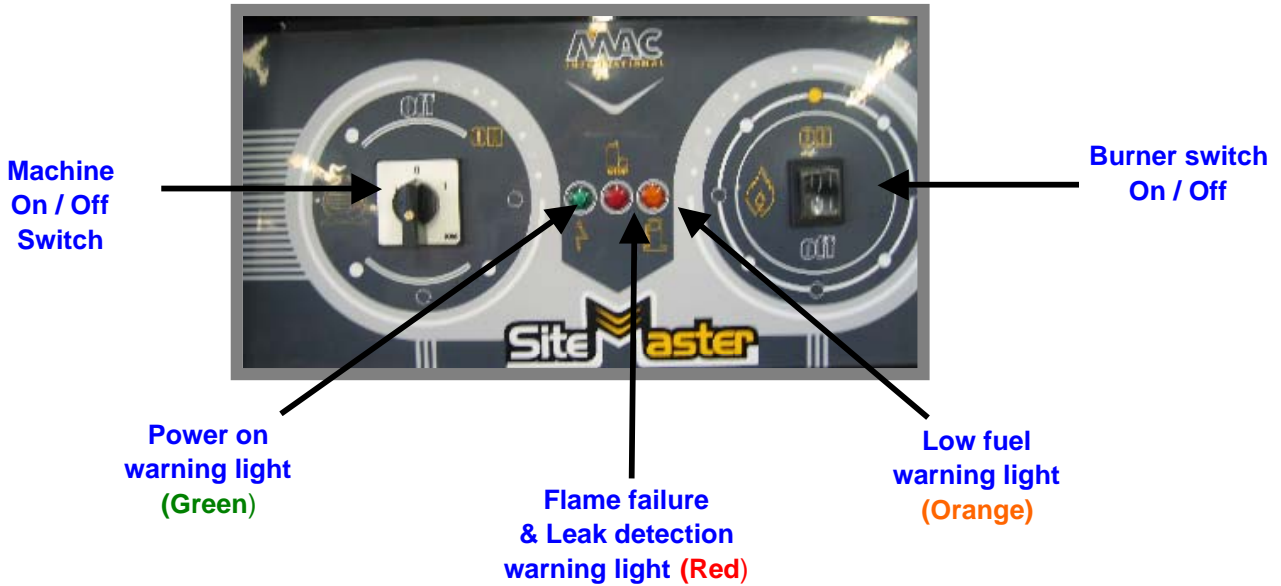

START AND STOP PROCEDURE

It is recommended to run machine without high-pressure hose after commissioning to remove air from pump.

1. After machine installation do not connect high-pressure hose.
2. Turn machine switch to the on position the machine will start up running cold only.
3. Run the machine until all air is cleared and water is flowing from the outlet.
4. Turn off machine and connect high –pressure hose.
5. Restart the machine and pump will come up to pressure.
6. On pulling the trigger You may experience "kick back" from gun, hold gun and lance with both hands.
7. On release of the trigger the machine will shut down after 9 seconds.

8. When the trigger is pulled machine will automatically restart
9. Always turn off the machine when not I use.
10. To run the burner, push the switch to the on position.
11. The burner will not ignite until the trigger is pulled on the lance. This has a 5-second delay.
12. Adjusting the thermostat located inside the cabinet can set the burner temperature.
13. After machine has been run on hot, cool machine down by switching off the burner and running the machine until lance is cool.

REDUCING THE PRESSURE

Turning the unloader valve anti-clockwise can reduce the pressure. This is located inside the machine.

WARNING!!!

This will also increase the working temperature of the machine, which can be controlled by the thermostat, which is located inside the machine.

CHEMICAL/SOAP VALVE

This machine is fitted with high-pressure inline chemical injection. We recommend a bulk tank of chemical outside the machine. There is room for a 25 litre drum within the cabinet.

1. Before Start check soap tank level, if the tank is empty do not use this could pull air into the pump and damage the pump seals.
2. See Appendix A if your machine is fitted with a chemical switch on the control panel.
3. After starting the machine turn the chemical valve anti clock wise. After a short time the chemical will start to come through, you can adjust the amount by turning the valve clock wise for less or anti clockwise for more.
4. Always turn off the chemical and run clean water through the pump before turning the machine off.

RECOMMENDATIONS ON COMMISSIONING

1. Set water temperature using thermostat located inside the machine eg. 70°C
2. Set up chemical dilution using the adjusting valve located inside the machine.
(Machines with chemical switch only)
3. All the above if pre-set will not need to be adjusted for normal use and keep access into the cabinet to a minimum.

RECOMMENDATIONS DURING RUNNING

1. Avoid constant ON/OFF trigger pulling when necessary.
2. Do not point lance at other persons etc.
3. Wear protective clothing when using pressure-cleaning equipment.
4. Cool burner on machine before turning off.

AVOID THE FOLLOWING

1. Never run machine without water.
2. Avoid dirty fuel at all times
3. Avoid using dirty container for filling fuel tank.
4. Running machine with damaged water filter.
5. Do not change lance nozzle without checking with supplier.

THE ABOVE INSTRUCTIONS ARE RECOMMENDATIONS, HOWEVER, FAILURE TO COMPLY WILL INVALIDATE ANY WARRANTY

Appendix (A)

Flame Failure Control

1. This machine is fitted with a flame failure system. This system is a photocell attached to the top of the burner unit which sees light when the burner is operational, if no light is detected within the allowed time the control board tells the fuel solenoid not to energise and a red light is lit.
2. If this occurs there could be a fault within the burner unit, which will be indicated by the lamp staying on constantly and the burner unit shutting down

Leak Protection System

1. This machine is also fitted with a drop to drop (leak protection) system. If this machine has a leak on the high-pressure outlet within the machine and detects the machine starting up more than 10 times the machine will shut down and the red light on the control panel will be lit.
2. If this occurs the same red light for the burner flame failure will be lit but this time it will flash indicating a leak protection fault.
3. To reset the machine for either of these faults simply turn the main switch off then back on again to clear the system. If the faults persist please contact your supplying dealer for an engineer.

Chemical Switch

1. The soap restriction valve is pre-set this is located inside the machine. If any air is in the soap line pressure will be lost for a short time until chemical is pulled through.
2. Push the chemical switch to the on position.
3. The chemical will start to come through the lance in a short time.
4. Always turn off the chemical and run clean water through the pump before turning the machine off.
5. The soap restriction valve adjusts the amount of chemical running through the machine. When set this can be controlled using the chemical ON/OFF switch.

PRESSURE WASHERS - HEALTH AND SAFETY INFORMATION.

BASIC RULES

Never point the gun at anyone even if machine is switched off.

Never work from a ladder.

Never use the gun with the trigger locked on.

Always ensure your equipment is in first class condition.

Always wear the correct protective equipment.

1. High-pressure jets are **DANGEROUS** is subject to misuse. The jet must not be directed at persons, animals, electrical equipment the machine itself or for any unauthorised purpose.
2. Operators should wear the necessary protective clothing to protect them from the particular liquid and material being treated.
3. Operators should be trained to follow a safe system of work and informed about potential hazards. Supervisors should ensure that operators follow the safe system of work.
4. The socket outlets should be protected by a Residual Current Device. Care should be taken to locate the device either where it will not be splashed, or alternatively the device should be suitably protected to IP55 (BS5490)
5. Plugs and sockets conforming to BS4343 should be used wherever practicable
6. All repairs are to be carried out only by Your Local Dealer . No modifications or changes to specification of this machine are allowed.
7. No machine shall be run without its guards, covers and safety equipment in place and in full working order. The machine should be used on level ground wherever possible.
8. Drainage of the working area should be good and care should be taken to avoid spillages.
9. Cables should be inspected regularly. Where cables are trailing on the ground extra care should be taken to prevent damage. Cables should be properly stored when not in use.
10. The pressure washer operating instructions should be followed at all times to ensure satisfactory results and prevent unnecessary damage/injury.
11. Users should be aware of the provisions of the Health and safety at Work Act and the Electricity at Work Regulations.
12. This machine has been designed for use with cleaning agents supplied or recommended by the manufacturer/supplier. The use of other cleaning agents or chemicals may effect its safety.

13. Any electrical connections must be the responsibility of a qualified electrician and comply with the latest edition of the IEE wiring regulations.
14. A documented routine maintenance system consisting of regular inspection testing and repair by a competent person should be established.

WARRANTY

This product has been constructed to a high specification from quality materials. It is warranted against mechanical or electrical defect in materials and workmanship and in the event of break-down within the warranty period should be returned to the dealer from whom it was purchased where, subject to compliance with the following conditions, the defective part will be repaired or exchanged free of charge.

1. The machine shall at all times be installed and operated in accordance with the instruction book and manual.
2. The warranty will not apply to any failure resulting from misuse or negligence on the part of the user.
3. No liability will be accepted under this warranty for damage caused by the fitting or use of other genuine parts or where any person other than a Recommended service engineer has carried out repair work.
4. This warranty does not apply to hoses, cables or wires nor to replacement of normal service and consumable items.
5. The warranty period shall be for one year from the date of purchase. The warranty is twelve providing the machine is only used on an average of one working shift per day. If the machine were used in excess of this, the warranty would be halved.
6. Liability under the warranty is limited to the replacement value of the machine or part and liability for any consequential loss suffered or caused is hereby expressly excluded.
7. The warranty shall not be applicable until the machine has been paid for in accordance with the terms of payment agreed at the time of sale.
8. This warranty is applicable only to the original purchaser and is not assignable or transferable.
9. No warranty repairs will be undertaken without proof of purchase.
10. This warranty applies only to the machines purchased and operated in the United Kingdom and Irish Republic.